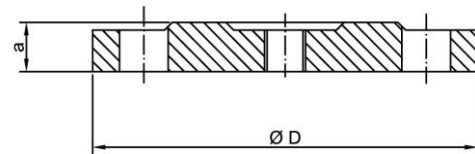

BLANK FLANGE BO-007

UNE-545

BODY PN10 / PN16 / PN25		
DN	Ø D	a
40	150	19
50	165	
60	175	
65	185	
80	200	
100	220	
125	250	
150	285	
200	340	20
250	405	22
300	460	24,5
350	520	26,5
400	580	28
450	640	30
500	715	31,5
600	840	36
700	910	39,5
800	1025	43

SPECIFICATIONS:

Made of **ductile iron**.
Blue epoxy painted finish.
 According to **UNE-EN 545** norms.

